



TECHNICAL GUIDE

March 2019



CONTINUOUS
INTERLOCKING
SOFFITS®

RIBON



RIBON LIMITED

P.O BOX 315-555

SILVERDALE 0932

WWW.RIBON.CO.NZ



This guide has been designed to assist the reader as a supporting document to achieve a successful specification for the use of Ribon Continuous Interlocking Soffits®.

Ribon Continuous Interlocking Soffits® is very unique to other soffit linings and will require attention to our details when specifying this product.

The information provided in this document gives the user an understanding how the system is applied to a building structure with relevant technical document information. The details and information in this document are not to be used specifically for specification and will require the user to source from Ribon Limited's resources, further construction details, technical documents and technical support. A full range of 50+ construction details are available in PDF & DWG format along with warranty standards, producer statement request and masterspec link is available within our website: www.ribon.co.nz

Further development and technical support is available at request.



CONTINUOUS
INTERLOCKING
SOFFITS®

/ RIBON



CONTENTS

What is Ribon Continuous Interlocking Soffits	4
How does it work	4
Where can it be used	4
Wind zone	5
Warranty	5
Maintenance	5
Masterspec	5
Approved installers	5
Soffit panel	6
SB 600-450-300	6
Wall bracket	6
Extension bracket	7
Panel joiner	8
Fascia panel	8
Details	9
Drop height tables	10
PS1 sample	11

What is Ribon Continuous Interlocking Soffits®:

Ribon Continuous Interlocking Soffits® is an integrated pre-finished metal fascia and soffit system designed for residential and commercial applications. It combines three existing applications into one less time consuming procedure, offering a much higher quality, low maintenance finish.

How does it work:

Ribon Continuous Interlocking Soffits® is a manufacture-supply-install service. The system consists of a heavy duty patented bracketing system that supports a roll formed 0.55BMT pre-painted fascia and/or soffit panel using interlocking technology, eliminating visible fixings.

We consolidate an over-resourced, time consuming conventional application consisting of builders, fascia installers and painters into one specialist install application.



Ribon Continuous Interlocking Soffits® relieves the builder of time consuming, traditional soffit framework with its integrated heavy duty engineered bracket that retains both a fascia panel and soffit panel via interlocking engagement and is applied in one easy procedure. Having an interlocking system is very advantageous being that it is not only quicker to install but there are no visible fixings leaving the surface uninterrupted. Another great advantage of our integrated brackets is that we achieve perfect engagement and retention between the fascia and soffit, being that the two components are made of the same material, makes them more compatible.

We custom measure and roll form our soffit panels to length to reduce cost by reducing waste to less than 3%. All waste can be recycled and not end up contributing to our land fills.

We use Colorcote® Magnaflow™ to manufacture our soffit panels and offer a 40+ colour palette to give the user an easy platform to co-ordinate their colour theme. Having a pre-finished product not only gives you a superior finish but eliminates time consuming hand painted products that will require difficult high maintenance such as a re-paint or stain in 6-10 yrs time.

Where can it be used:

RCIS is a great alternative solution for any residential or commercial eave. It can be used externally as well as internally and is perfect for entrance ways, portico's or any large feature area.

- Residential
- Commercial
- Retail
- Multi-level housing

Please consider the local environment when specifying this product as certain environments can cause early deterioration of the paint surface and consideration must be taken when applying close to the coast or geothermal environments. Some environments may require more frequent manual washing. Please visit: www.colorcote.co.nz- Atmospheric Environment usage guide for Magnaflow™:

Colorcote® gives Magnaflow™ a 10yr warranty extending from 100-400m from the coast when used in a soffit environment and in accordance to their warranty conditions. Please ask us for your specific warranty.



WIND ZONE: Ribon Continuous Interlocking Soffits® have been designed and tested to meet the relevant codes for wind actions AS/NZS 1170.2:2002. This system has been tested to withstand an equivalent NZS3604 very high wind zone loading.

For specific design wind loadings for multi-level buildings, the Ribon system has been independently tested to meet wind loadings up to 2.4KPa.

WARRANTY: For use within the warranty standard conditions, Colorcote® gives Ribon Continuous Interlocking Soffits® a warranty for application in a soffit environment for a maximum of:

10 yrs: Paint

10 yrs: Perforation

Ribon Limited gives a 10 yr warranty on workmanship provided by an approved installer.

MAINTENANCE: Ribon Continuous Interlocking Soffits® require a periodic manual wash down with just water and a soft brush to maintain its high quality finish and ensure longevity of the product. Depending on your environment, some will require more frequent wash downs than others.

Maintenance requirements are issued with your specific Colorcote® warranty.

MASTERSPEC: Please find our specification in section: 4239RB Ribon Metal Soffits.

www.masterpec.co.nz

APPROVED INSTALLERS:

Ribon Limited (National)

Contact: Keith Russell

PH: 022 641 0942

E: keith.russell@ribon.co.nz

RIBON PANEL



Roll formed from 0.55BMT G300 Magnaflow™ by Colorcote®. A highly durable product with zinc/aluminium/magnesium alloy coated steel- 275gms/m² coating weight topped off with a corrosion resistant chromate conversion coating.

Paint finish in either polyester or PVDF coatings (Magnaflow X).

Effective cover= 149.5mm

Max practical length= 8.000m– Longer lengths can be achieved but will depend on access and length required. Please consult Ribon Limited for non-standard lengths before specification.

SB 600– SB 450– SB 300

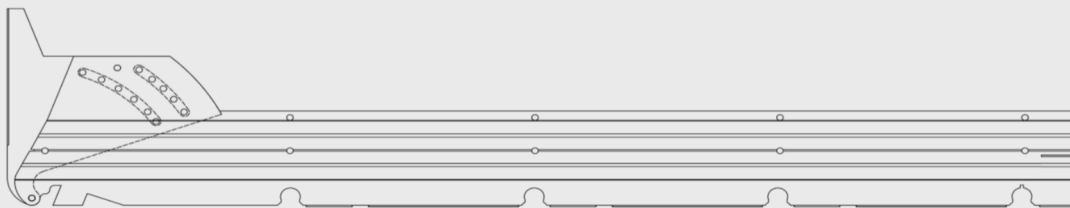

SB 600

Manufactured from 1.0mm Zinalume or Duralume, this two-piece bracket comes pre-assembled as a fascia and soffit bracket in 3 typical soffit widths- 300/450/600mm and can articulate (max. 20deg) to service both sloping and flat eaves. This bracket will only extend to its given length and beyond this will require the adaption of our Extension Bracket (see below). The SB bracket is screw fixed to each rafter at 900mm centres maximum.

RIBON U-CANNEL– WB6M

Manufactured from 1.0mm Zinalume or Duralume, the U-Channel comes in 6m lengths. The U-Channel screw fixes at 600mm centres to the wall framing at the required drop height (see drop height tables below) and supports the end of the SB in a flat soffit detail.

It is also may be used for suspension hangers to achieve greater drop down heights for the Extension Bracket.

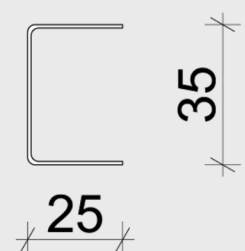

EXTENSION BRACKETS

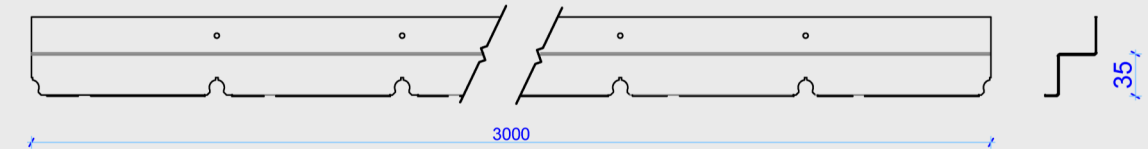

EB3M

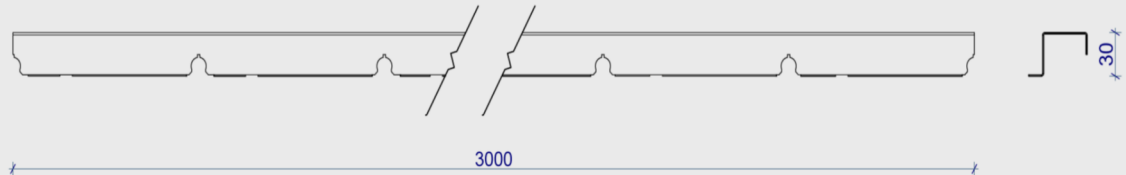

EB3M2

Extension brackets with cross section

Manufactured from 1.0mm Zincalume or Duralume, the EB3M & EB3M2 are available in 3m lengths. It is used as the supporting brackets for larger area of eaves, such as a portico, balcony or large commercial eaves.

The EB3M is designed for lateral fixing to the building frame. This allows for a restricted vertical adjustment to achieve true alignment. When a greater drop down distance is required, suspension hangers can be set at 600mm centres to support and lower the bracket to the required height.

The EB3M2 is designed for when side fixing cannot be achieved, either when an extension bracket must run perpendicular to the building frame or for direct fixing to the underside of a concrete slab.

Maximum spacings for fixings = 600mm centres

Maximum spacings for brackets = 900mm centres

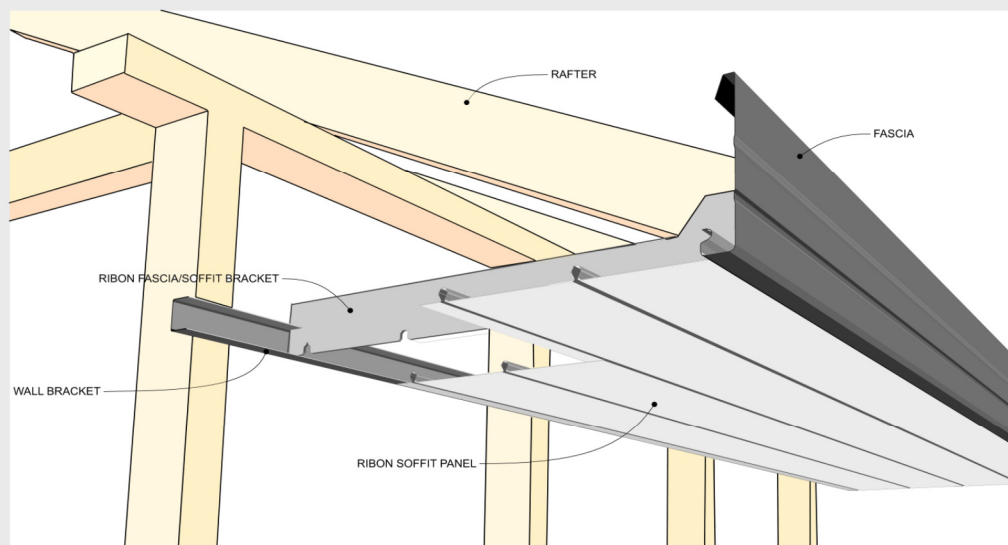

MULTI-FIT™ FASCIA PANEL

Ribon Limited chooses Multifit™ fascia panel from Roofing Industries as the most compatible fascia for our system.

Multifit™ fascia panel is available in 150mm, 165mm and 185mm with our system.

The fascia panel will be manufactured from 0.55BMT G300 Colorcote® Magnaflow™ and will have a maximum practical length of 8.000m.

Multifit™ fascia panel is a external fascia system. Any generic spouting can be adapted to the face surface of the panel.

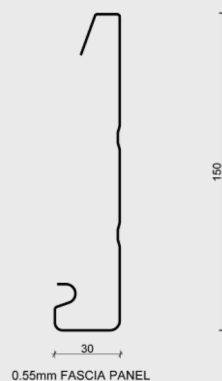

PANEL JOINER

The panel joiner is a powder coated aluminium extrusion. It is available in 4m lengths. The panel joiner works as a two-piece system with one over the top of the other. Once cut to length and holes pre-drilled, it will be screw fixed or riveted together clamping onto the panels providing support and hiding any cut edges or mitres.

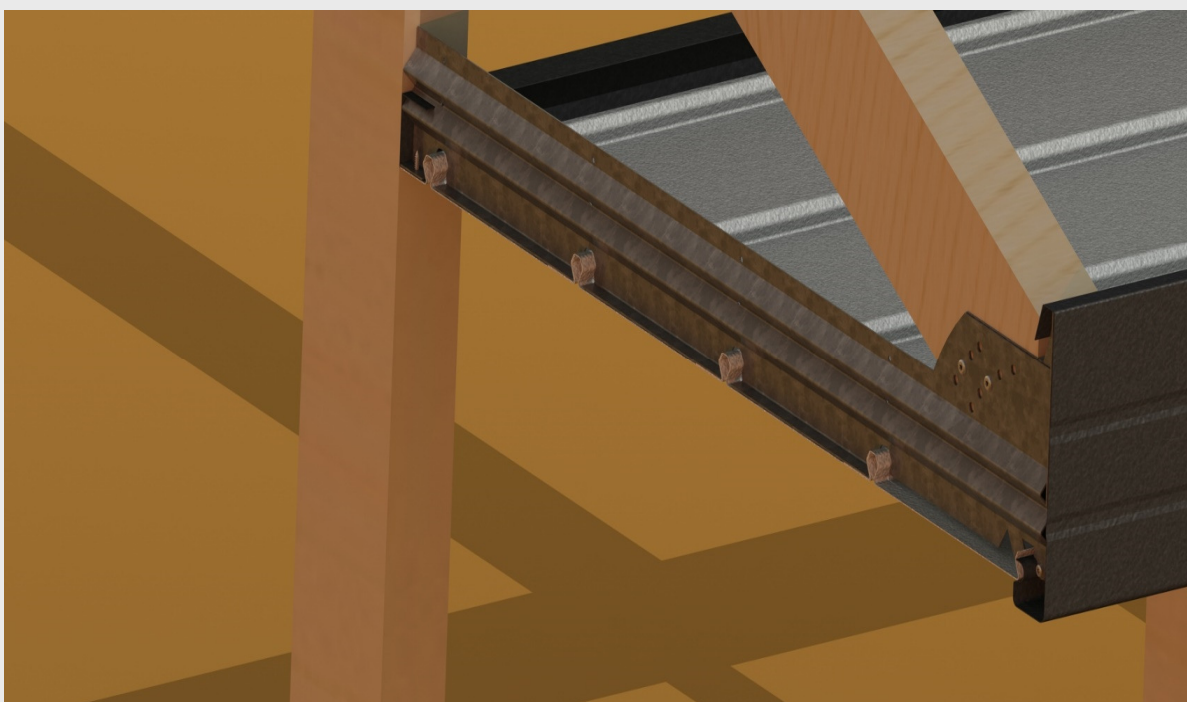
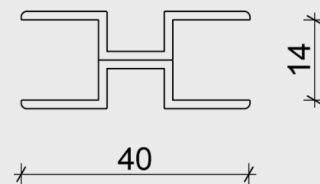

TYPICAL TECHNICAL DETAILS

Please visit our website—www.ribon.co.nz, for a full range of 50+ details in PDF & DWG formats.

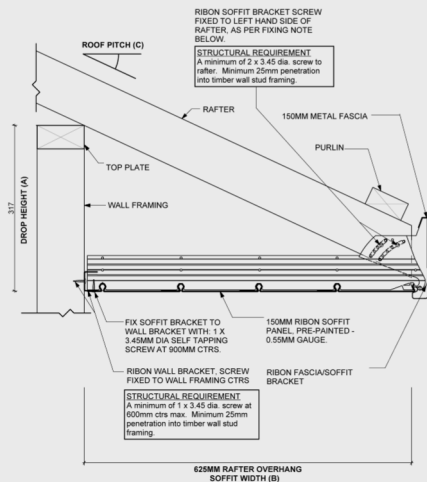

D 01 - 625 625MM SOFFIT DETAIL (METAL ROOF) 1:5

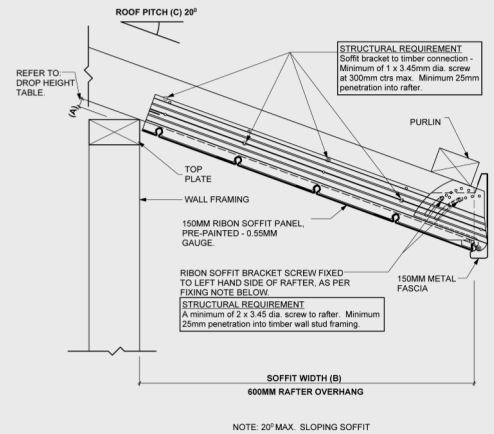

D 12 600 600 SLOPING-DOWN SOFFIT DETAIL (METAL ROOF) 1:5

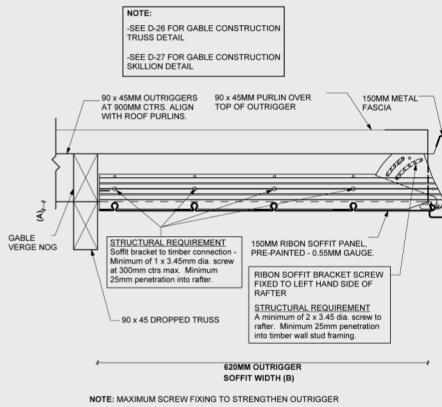

D08 620 620 BARGE DETAIL - (METAL ROOF) 1:5

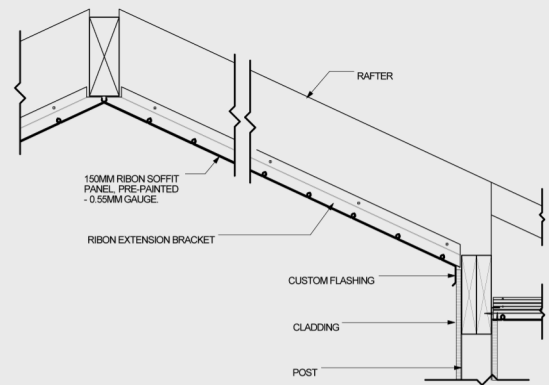

PORTICO DETAIL

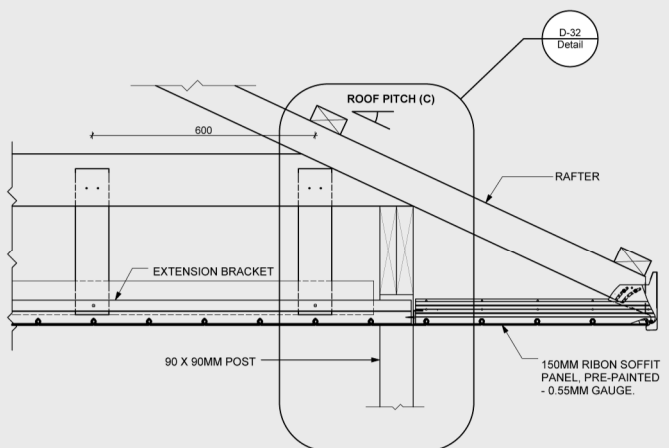
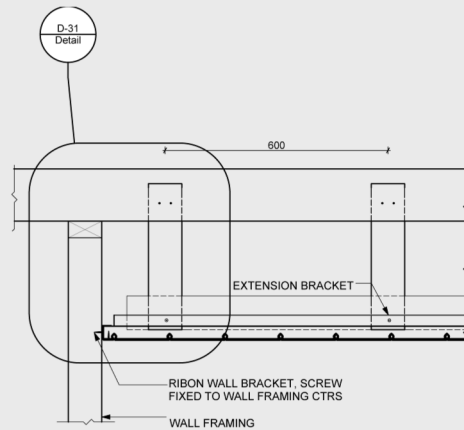

SUSPENDED SOFFIT DETAIL

CONTINUOUS
INTERLOCKING
SOFFITS®

RIBON



DROP HEIGHT TABLES- FLAT SOFFIT

TABLE 1

LONG RUN OR METAL TILE ROOFS										
ROOF PITCH (C)										
	5	10	15	20	25	30	35	40	45	
SOFFIT	325	52	82	113	143	175	211	251	295	344
WIDTH	475	67	110	155	200	248	300	358	423	496
(B)(mm)	625	81	138	195	255	319	386	463	548	645
DROP HEIGHT (A)(mm)										

TABLE 2

CONCRETE TILE ROOFS										
ROOF PITCH (C)										
	5	10	15	20	25	30	35	40	45	
SOFFIT	325	N/A	N/A	71	101	131	164	202	242	276
WIDTH	475	N/A	N/A	114	158	203	253	309	370	439
(B)(mm)	625	N/A	N/A	154	212	273	340	414	496	588
DROP HEIGHT (A)(mm)										

TABLE 3

ASPHALT TILE ROOFS										
ROOF PITCH (C)										
	5	10	15	20	25	30	35	40	45	
SOFFIT	325	N/A	118	149	181	214	249	288	330	379
WIDTH	475	N/A	147	191	238	286	338	395	458	531
(B)(mm)	625	N/A	173	232	292	356	425	500	584	680
DROP HEIGHT (A)(mm)										

DROP HEIGHT TABLES- GABLE END

TABLE 4

GABLE END DROP HEIGHT FOR LONGRUN OR METAL TILE ROOFS (90X45MM OUTRIGGER ON EDGE)										
ROOF PITCH (C)										
	5	10	15	20	25	30	35	40	45	
SOFFIT	325	25	25	24	23	21	19	18	15	11
WIDTH	475	25	25	24	23	21	19	18	15	11
(B)(mm)	625	25	25	24	23	21	19	18	15	11
DROP HEIGHT (A)(mm)										

TABLE 5

GABLE END DROP HEIGHT FOR CONCRETE TILE ROOFS (90X45MM OUTRIGGER ON FLAT)										
ROOF PITCH (C)										
	5	10	15	20	25	30	35	40	45	
SOFFIT	325	N/A	N/A	30	29	33	24	22	20	18
WIDTH	475	N/A	N/A	30	29	33	24	22	20	18
(B)(mm)	625	N/A	N/A	30	29	33	24	22	20	18
DROP HEIGHT (A)(mm)										

TABLE 6

GABLE END DROP HEIGHT FOR ASPHALT TILE ROOFS 90x45 OUTRIGGER ON EDGE										
ROOF PITCH (C)										
	5	10	15	20	25	30	35	40	45	
SOFFIT	325	N/A	57	57	55	53	49	45	40	33
WIDTH	475	N/A	57	57	55	53	49	45	40	33
(B)(mm)	625	N/A	57	57	55	53	49	45	40	33
DROP HEIGHT (A)(mm)										

DROP HEIGHT TABLES- SLOPING SOFFIT

TABLE 7

SLOPING SOFFIT DROP HEIGHT- Metal Roofs 20deg max.			
SOFFIT BRACKET LENGTH (mm)	325	475	625
DIMENSION (A)(mm)	150	300	450
DROP HEIGHT (mm)	20-25	20-25	20-25

TABLE 8

SLOPING SOFFIT DROP HEIGHT- Asphalt Roofs 20 deg max.			
SOFFIT BRACKET LENGTH (mm)	325	475	625
DIMENSION (A) (mm)	150	300	450
DROP HEIGHT (mm)	55-60	55-60	55-60

PRODUCER STATEMENT

NANCEKIVELL CAIRN LIMITED

Civil & Structural Engineers

34a Constellation Drive Rosedale,
Auckland 0632.
PO Box 35377, Browns Bay,
Auckland 0753, New Zealand.

Telephone
Facsimile
email
Website

(09) 479 7028
(09) 479 7062
engineer@ncl.co.nz
www.ncl.co.nz

25 August 2016

Our Ref: 21389

Ribon Limited
PO Box 486
Whangarei 0140

RIBON CONTINUOUS INTERLOCKING SOFFIT – PRODUCER STATEMENT

Nancekivell Cairn has been engaged by Ribon limited to provide specific structural design services in respect of the requirements of Clause B1 Structure of the New Zealand Building Code.

The designs have been prepared on the basis of the relevant New Zealand codes for wind actions AS/NZS 1170.2:2002.

The Ribon continuous interlocking soffits have been tested to withstand an equivalent NZS3604 very high wind zone loading.

The designs are contained in the Ribon continuous interlocking soffits limited design manual – Revision 1.

As an independent design professional covered by a current policy of Professional Indemnity Insurance to a minimum value of \$200,000 I BELIEVE ON REASONABLE GROUNDS that the Ribon continuous interlocking soffits designed and erected in strict adherence to the advise and disclaimers contained in the Ribon continuous interlocking soffits limited design manual – revision 1 will comply to the relevant provisions of the building code.

Yours faithfully



Jade Vaotogo
CPENG 1006448

Director Bruce Nancekivell BE MIPENZ CPENG IntPE(NZ)

Director David Cairn NZCE (Civil) TIPENZ

G:\JobFolder\21300-21399\21389\Working\PS1 Cover Letter.docx

V11 June 2015

CONTINUOUS
INTERLOCKING
SOFFITS®

RIBON